



JSPD-801

ACCESSORY GROUP AUTOMATIC - SENSOR ACTIVATED SOAP DISPENSER

SUBMITTAL DATA



Features:

- Automatic operation via sensor activation.
- ADA compliant.
- Stainless steel body.
- Pre-measured dispensing volume (1-1.5ml).
- Reservoir capacity 900ml - refillable.
(800 ml disposable supplied by others).
- Sensor detection range adjustable
(2.4 - 1.5 inches) (60 - 38 mm)
- Sensing delay - 0.5 - 1 sec.
- Room temperature 41°F ~ 104°F (5°~40°C)
- Viscosity range 1~3000 (cP)(mPas)
- Self contained valve/nozzle (Peristaltic tube).
- Battery operated (6) AA size alkaline (1.5V).
- Battery life aprox 1 year (35,000 activations).

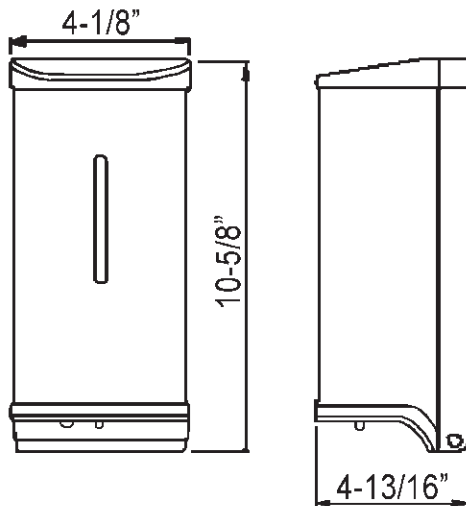

APPROVED FOR MANUFACTURING	
MODEL NO.:	QTY:
JOB NAME:	
TAG/ITEM:	
CUSTOMER:	
SIGNATURE:	

JUST MFG. COMPANY CONTINUES TO MAKE QUALITY AND FUNCTIONALITY A MARK OF THE JUST PRODUCT LINE. WE RESERVE THE RIGHT TO CHANGE PRODUCT INFORMATION WITHOUT NOTICE. DIMENSIONS MAY CHANGE AND MAY BE SUBJECT TO CHANGE WITHOUT NOTICE. NO RESPONSIBILITY IS ASSUMED FOR USE OF SUPERCEDED OR VOIDED DATA. JUST MFG. CO. SINKS ARE MADE IN THE U.S.A. WHEN COMPARING OTHER BRAND PRODUCTS, BE SURE TO COMPARE USA QUALITY ALONG WITH FEATURES AND DIMENSIONS.

JUST MANUFACTURING COMPANY

9233 KING STREET . FRANKLIN PARK . ILLINOIS . 60131-2111

PH: 847-678-5150 . FAX: 847-678-6817 . E-MAIL: custserv@justmfg.com . www.justmfg.com

INSTALLATION - TILE and DRYWALL

1. Tape the installation template at the appropriate location on the mounting surface.
2. Drill (4) holes at the marked locations 5/16" (08mm) dia.
3. Insert (4) plastic anchors (supplied) into the drilled holes (Fig.1). Remove template.
4. Insert (2) screw (supplied) into the top plastic anchors (Fig.2). Partially tighten until approx. 1/8" space remains under screw head (Fig. 3).
5. Hang the dispenser on the two screw through the keyhole slots at the top of the backplate.
6. Use key to unlock the cover. Pull housing cover forward (Fig. 4).
7. Remove soap tank and install the (2) remaining screws at the bottom of the backplate (Fig. 5).

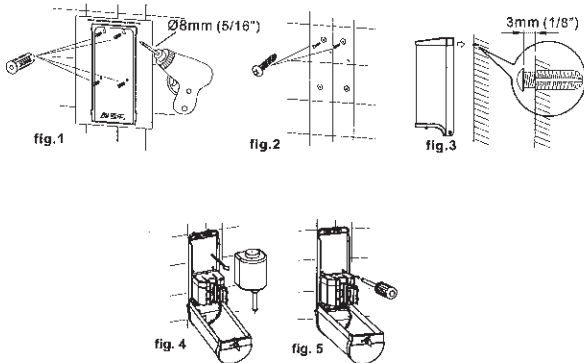
**INSTALLATION - MIRROR SURFACES****(using adhesive strips)**

1. Clean surface of the area where the dispenser is to be mounted with isopropyl alcohol.
2. Mark the outline of the dispenser on the mirror using masking tape.
3. Remove the paper liners from the adhesive pads on the rear of the backplate.
4. Place unit on mounting surface with even steady pressure and hold for 1 minute.
5. Let tape cure for 10 hours prior to filling dispenser with soap for first time use.

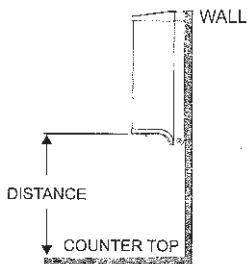

DISTANCE (MINIMUM TYPICAL)
NORMAL COUNTER TOP
 At least 200mm (7-7/8")
STAINLESS STEEL COUNTER TOP
 At least 300mm (11-13/16")

SENSING RANGE ADJUSTMENT

Sensing range is pre-set and adjusted by the factory to be 2-9/16" (65MM) TO 5/8" (15MM)

Adjustment of the range is NOT RECOMMENDED. In the event that the range must be adjusted follow these steps.

1. Remove the label on the bottom of the housing to expose the service access hole.
2. Use a flat blade screwdriver to rotate the potentiometer knob inside the control module. Do not adjust more than 1/4 turn at a time, then test results.
Increase distance - Clockwise (CW)
Decrease distance - Counter-Clockwise (CCW)

**INSTALLATION
and
OPERATING INSTRUCTIONS****OPERATING INSTRUCTIONS**

1. Unlock housing using security key.
2. Open cover on battery compartment, remove battery box and unplug cable; install (6) new Alkaline Type AA 1.5V batteries, taking care to install with correct polarity (+/- indication) to obtain 4.5V +/- 10% at the plug.
3. Reinstall battery box and close compartment cover.
4. Remove, clean and fill soap tank with appropriate viscosity liquid soap. Ensure that the soap tank cover is closed and the air vent hole is open, the nozzle is not clogged and the exterior of the soap tank is clean (no spill over). *a. NOTE - Disposable soap cartridges (800ml) may be used in place of the soap tank that was included in the package.*
5. Install the soap tank into the dispenser. Make sure the nozzle flange is below the housing cradle rib to stretch the valve tube.
6. Latch the cradle gate.
7. Test ready condition by pushing up on the cover safety interlock switch (blue stem) on bottom. Click and hold to check that the blue LED light is lit and then flashes (3) times indicating proper "stand-by" condition and battery charge level .
8. Close the housing cover and lock with security key.
9. Trigger the sensor with hands or towel to check proper soap dispensing cycle.

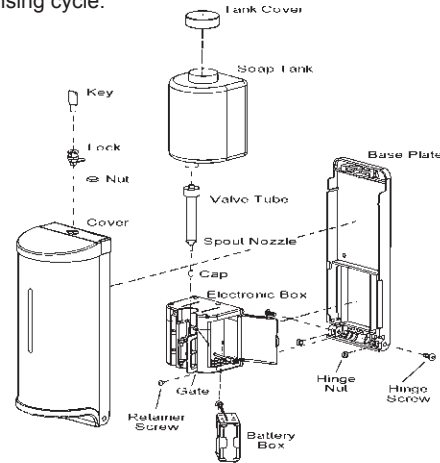
**IMPORTANT NOTICE**

1. Make sure no bright light source is aimed or reflected at the sensor from below.
2. Use fresh, new liquid soap only. Clean soap tank properly before each re-fill. Deposits of old soap will lead to malfunction and jamming.
3. Do not dilute liquid soap unless it is concentrate and DO NOT USE SOAP CONTAINING ABRASIVES. Observe viscosity factors of liquid soaps to be used.
4. Do not immerse soap dispenser (control box/housing) under water. This will cause a short circuit .

LOW BATTERY INDICATOR

Open housing cover and remove soap tank. to perform the following diagnostic test.

1. Press (push up) and hold blue safety unlock switch on bottom.
2. Check that the blue LED is lit and then flashes (3) times indicating proper "stand-by" condition and battery charge level .
3. If LED continues to flash blue, the batteries need to be replaced.

JUST MANUFACTURING COMPANY

9233 KING STREET . FRANKLIN PARK . ILLINOIS . 60131-2111

PH: 847-678-5150 . FAX: 847-678-6817 . E-MAIL: custserv@justmfg.com . www.justmfg.com